

SE Spa Electrics®

retro

REPLACEMENT LED POOL LIGHT



**POOL LIGHT
1½" STD THREAD &
HAYWARD INSTALL**

T1

**R1 - 1½" STD THREAD & HAYWARD
INSTALLATION & OWNER'S MANUAL**

CONTENTS

READ THIS FIRST	5	
TOOLS REQUIRED	6	
INCLUDED PARTS	7	
INSTALLATION	INTRODUCTION	8
	1: REMOVE EXISTING LIGHT	11
	2: CONNECTION TO CABLE	12
	3: 1 ½" THREADED ADAPTOR INSTALL	17
	4: 1 ½" PIPE FRICTION SLEEVE INSTALL	20
	5: LIGHT ASSEMBLY	22
RIM & SLEEVE REMOVAL	27	
RIM & SLEEVE INSTALL	28	
WINTERIZATION	30	
KEY DIMENSIONS	36	
TROUBLESHOOTING	37	
ELECTRICAL GROUNDING & FCC COMPLIANCE STATEMENT	38	

IMPORTANT



A **12V AC** TRANSFORMER MUST BE INSTALLED.
DC POWER SUPPLIES ARE NOT COMPATIBLE.

NOTE



FRESH WATER USE ONLY
NOT INTENDED FOR OPERATION OUT OF WATER

PRE-INSTALLATION CHECK

1 CHECK POWER SUPPLY

1A: IF THE POOL LIGHTS ARE DIRECTLY CONNECTED TO A 120V POWER SUPPLY, DO NOT CONTINUE INSTALLATION.

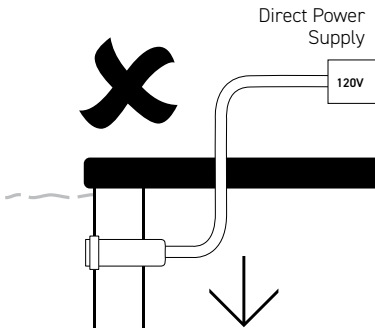

1B: A 12V AC TRANSFORMER **MUST** BE INSTALLED BETWEEN THE 120V POWER SUPPLY AND POOL LIGHT.

2A: IF THE POOL LIGHTS ARE CONNECTED TO A TRANSFORMER CHECK THAT IT MEETS STEP 2 REQUIREMENTS.

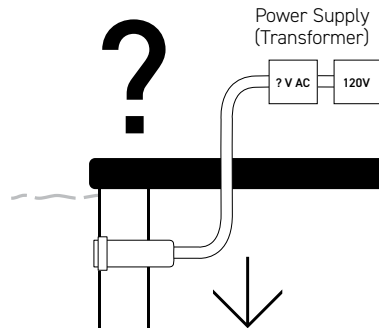

2B: IF THE TRANSFORMER DOES NOT MEET THE REQUIREMENTS, IT WILL REQUIRE REPLACEMENT.

2 ADD TRANSFORMER (IF NEEDED)

EXISTING TRANSFORMER MUST BE:

- UL Listed Isolating Low Voltage power supply, evaluated for swimming pool use
- Installed as per current NEC wiring rules
- 12~14v AC output
- Minimum 8w per **Retro T1** light
- In good working order

EXISTING TRANSFORMER MUST NOT BE:

- DC or 'LED Driver'
- Electronic or Switch mode
- Weather damaged or in otherwise poor condition

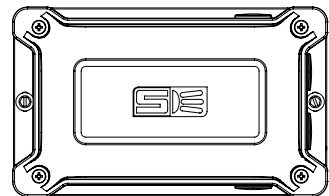

Spa Electric recommends "LVX" safety transformers for use with **Retro T1** lights

(LVX 50 & LVX 100)

PRE-INSTALLATION CHECK

3 CHECK CABLE THICKNESS

RETRO T1 CAN BE FITTED TO CABLES FROM 9/32" (7MM) UP TO 15/32" (12MM) DIAMETER.



4 CHECK FITTING TYPE

THIS SPA ELECTRICS RETRO T1 LIGHT IS DESIGNED TO BE INSTALLED IN MULTIPLE DIFFERENT APPLICATIONS:

- **INSTALLATION TYPE A: 1 1/2" SCH40 THREADED BULKHEAD** IN A FIBERGLASS, VINYL OR CONCRETE POOL.
- **INSTALLATION TYPE B: HAYWARD 1 1/2" NON-THREADED BULKHEAD** IN A FIBERGLASS, VINYL OR CONCRETE POOL.
- **INSTALLATION TYPE C: DIRECTLY INTO 1 1/2" SCH40 PIPE** IN A CONCRETE POOL.

SEE THE FOLLOWING ILLUSTRATIONS OF EXAMPLES FOR REFERENCE ONLY. (The bulkheads in your own pool may appear different depending on the original manufacturer and the installation type).

TYPE A: 1 1/2" SCH40 THREADED BULKHEADS

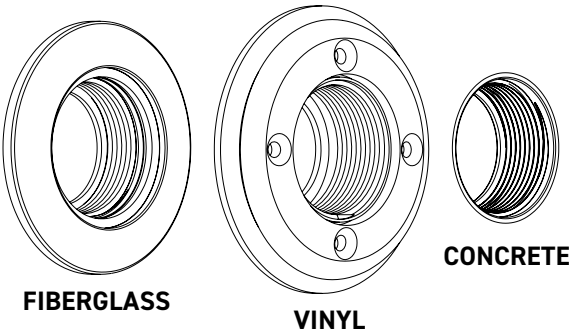

TYPE B: HAYWARD 1 1/2" NON-THREADED BULKHEADS

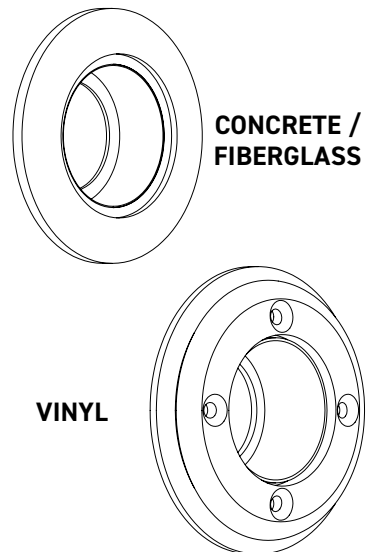

TYPE C: 1 1/2" SCH40 PIPE

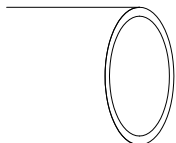

READ THIS FIRST

Congratulations on your purchase of a Spa Electrics **Retro T1** Series Pool Light. This light has been designed in conjunction with leading pool professionals across the USA and manufactured solely in Australia.

The **Retro T1** Series light is designed to quickly and easily replace existing LOW VOLTAGE, nicheless light fittings from major brands.

For safe and proper installation, please read this manual in full before commencing installation and use only the parts (screws, plugs, sealant etc) as provided.

For operating instructions, please refer to the MULTI PLUS Installation & User Guide.

- For safe and proper installation, ensure that only those parts supplied with the system are used.
- Maximum installation depth for the **Retro T1** light is 20" below water line (to top of light).
- The **Retro T1** light must be correctly installed in or on the wall of the pool with the top of the lens no less than **4"** below the nominal water level.
- All lights should be mounted in a location that is easily accessible without the need for entering or lowering the pool water.
- If cleaning the product is required, only use warm water and a soft brush or cloth to clean **Retro T1** lights. **DO NOT** use detergents or spirits as this can damage the light and void your warranty.
- Operating the light for at least 30 minutes every week is advised (unless removed and stored safely for winter months).
- **Retro T1** lights are suited for both domestic and commercial installations and can be operated continuously (24/7) if required.
- Temperature range for installation, operation and servicing: +32°F ~ +104°F (0°C ~ +40°C)

WARNING



- The **Retro T1** Light must be water cooled at all times. DO NOT switch the light on until installation is complete and the light is fully submerged in water.
- Ensure only circular cable not exceeding 15/32" (12mm) diameter is connected to the **Retro T1** Light. The use of Fig. 8 or non circular cable will not seal correctly & will void the product warranty.
- The **Retro T1** LED Light does not contain any user serviceable parts, opening the light will void the product warranty.
- Pool chemicals & PH levels: Due to the corrosive nature of unbalanced pool chemicals, Spa Electrics strongly recommend that your pool water is balanced prior to installing your pool Lights or any plastic or stainless steel components, and tested weekly to maintain these levels. pH levels should be maintained between 7.2- 7.6 at all times to ensure the longevity of these components.
 - Failure to do so can result in chemical damage to the light housing and pool fittings, including stainless steel components.
 - Please note: Lights or components found to have excessive chemical damage will not be covered under our manufacturer's warranty policy

TOOLS REQUIRED

- ✓ Draw wire
- ✓ Pliers or side cutters
- ✓ Small flat-blade screw driver
- * OPTIONAL: Teflon tape
- * OPTIONAL: Neutral Curing Silicone

IMPORTANT NOTES



- The use of power tools during installation is **not** recommended as these devices can cause faults and damage to light components.
- All installation steps should be carried out with manual tools only.
- The enclosed images are for illustrative purposes only. Appearances of parts and assemblies may vary from the enclosed illustrations
- Please contact Spa Electrics or contact us below if you have any questions regarding the correct installation of this product.

PRODUCT SUPPORT AND INFORMATION

For the most up to date installation information and contact information for assistance in your region, please visit www.spaelectrics.com

INCLUDED PARTS

CABLE ASSEMBLY (P/N: T1 18AWG 0.5)

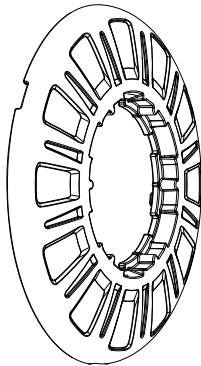
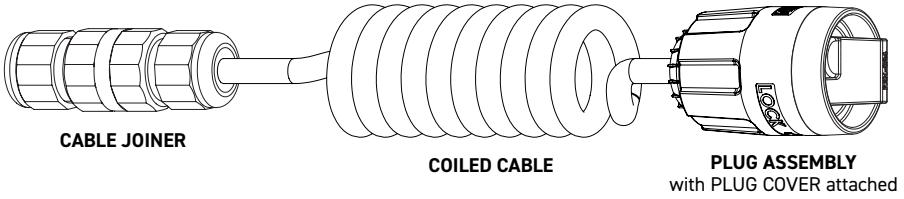

LARGE RIM
(P/N: T1FV 004)

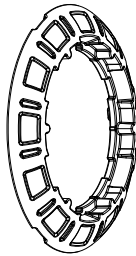

SMALL RIM
(P/N: T1C 004)
*pre-attached to
Light Assembly*

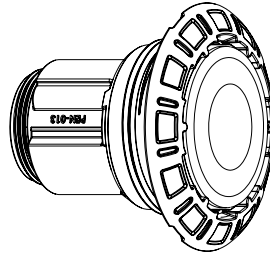

LIGHT ASSEMBLY
*with SMALL RIM &
THREADED SLEEVE
pre-attached*



**LIGHT
INSTALLATION
TOOL**
(P/N: T1 016)

INSTALLATION TYPE B

1 1/2" NON-THREADED BULKHEAD ADAPTER (P/N: T1 005)

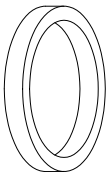

VINYL SPACER
*Required for
Vinyl Non-Threaded
Bulkheads*

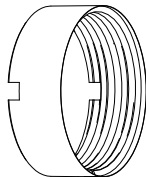

**1 1/2"
THREADED
ADAPTER**

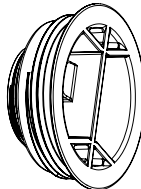

**1 1/2"
THREADED
CAP**
(Non-sealing)

INSTALLATION TYPE C

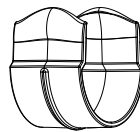

**1 1/2" PIPE FRICTION
SLEEVE**
(P/N: T1 006)

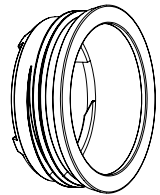

THREADED SLEEVE
(P/N: T1 017)
*pre-attached to
Light Assembly*

REQUIRED PART (NOT INCLUDED)



UL LISTED ISOLATING LOW VOLTAGE POWER SUPPLY, EVALUATED FOR SWIMMING POOL USE.

Installed as per current NEC wiring rules. 12-14v AC output. Minimum 8W per Retro Series Pool Light. Spa Electrics recommends "LVX" safety transformers for use with Retro Universal lights

INSTALLATION INTRODUCTION

THE FOLLOWING INSTALLATION INSTRUCTIONS FOR THE RETRO T1 LIGHT ARE SPLIT INTO 5 SECTIONS. DEPENDING ON YOUR INSTALLATION TYPE (A, B OR C), DIFFERENT SECTIONS ARE TO BE FOLLOWED AND SKIPPED. SEE THE DETAILS BELOW FOR WHICH SECTIONS SHOULD BE USED FOR EACH INSTALLATION TYPE:

TYPE A 1 1/2" SCH40 THREADED BULKHEAD

INSTALLATION TYPE A: 1 1/2" SCH40 THREADED BULKHEADS

FOLLOW INSTALLATION SECTIONS:

- 1: REMOVE EXISTING LIGHT
- 2: CONNECTION TO CABLE
- 5: LIGHT ASSEMBLY

EXAMPLES OF 1 1/2" SCH40 THREADED BULKHEADS:

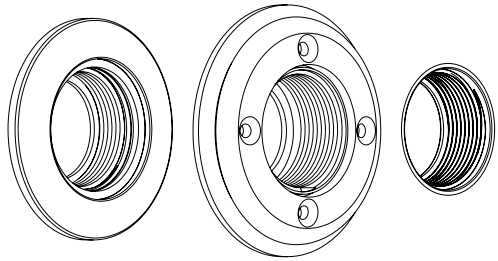

REQUIRED PARTS:

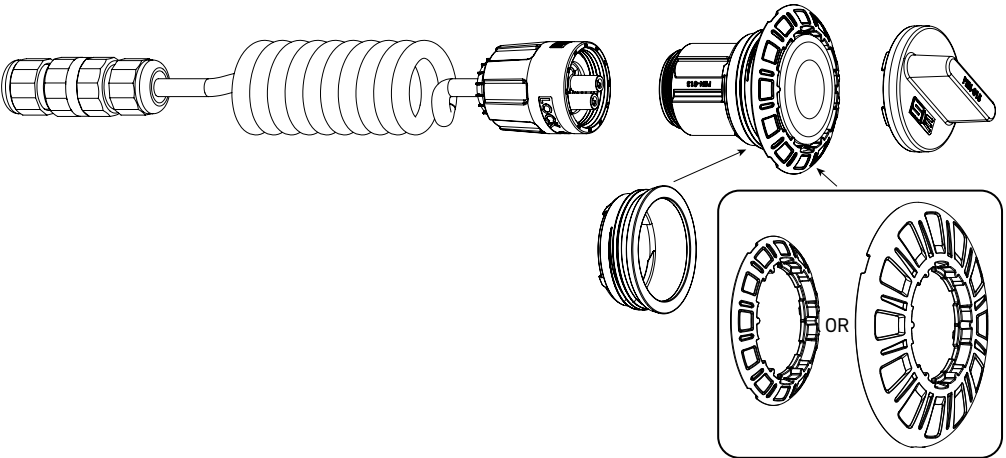

LOOK OUT FOR SECTIONS APPLICABLE TO A **TYPE A** INSTALLATION.

A B C

1: REMOVE EXISTING LIGHT

TYPE B

HAYWARD 1 1/2" NON-THREADED BULKHEADS

INSTALLATION TYPE B: HAYWARD 1 1/2" NON-THREADED BULKHEADS

FOLLOW INSTALLATION SECTIONS:

- 1: REMOVE EXISTING LIGHT
- 2: CONNECTION TO CABLE
- 3: 1 1/2" THREADED ADAPTOR
INSTALL
- 5: LIGHT ASSEMBLY

EXAMPLES OF HAYWARD 1 1/2" NON- THREADED BULKHEADS:

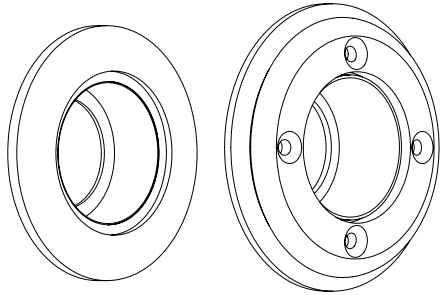

REQUIRED PARTS:

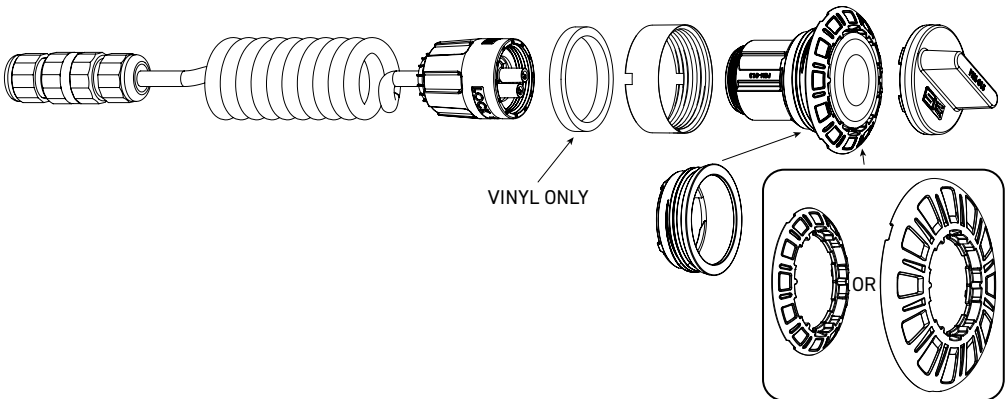

LOOK OUT FOR SECTIONS
APPLICABLE TO A **TYPE B**
INSTALLATION.

A B C

1: REMOVE EXISTING LIGHT

TYPE C 1 1/2" SCH40 PIPE

INSTALLATION TYPE C: 1 1/2" SCH40 PIPE

FOLLOW INSTALLATION SECTIONS:

- 1: REMOVE EXISTING LIGHT
- 2: CONNECTION TO CABLE
- 4: 1 1/2" PIPE FRICTION SLEEVE INSTALL
- 5: LIGHT ASSEMBLY

EXAMPLE OF 1 1/2" SCH40 PIPE:

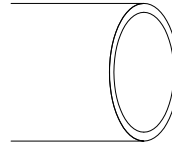

REQUIRED PARTS:

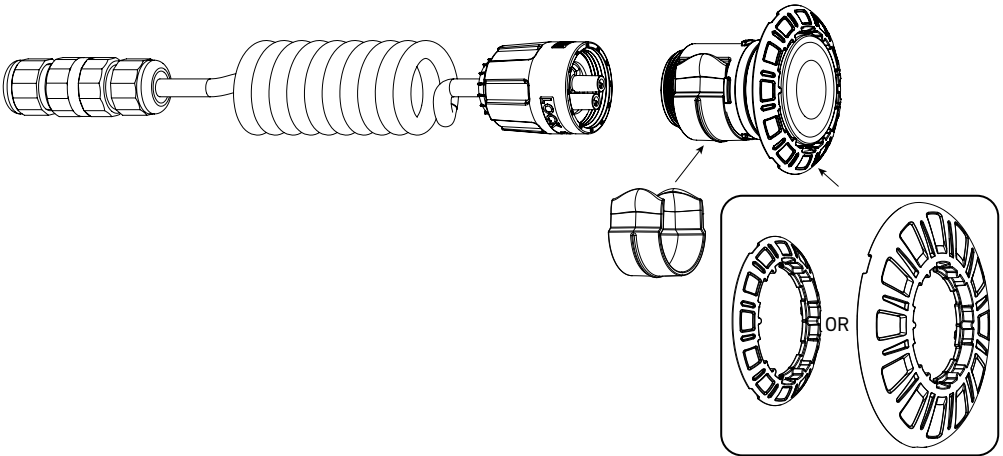

LOOK OUT FOR SECTIONS APPLICABLE TO A **TYPE C** INSTALLATION.

A B C

1: REMOVE EXISTING LIGHT

1: REMOVE EXISTING LIGHT

**STOP! WARNING
ELECTROCUTION**

CHECK POWER
IS TURNED OFF
FIRST



TURN
POWER
OFF



OFF

TURN OFF
BREAKER
TO POOL LIGHT
TRANSFORMER

- 1: REMOVE EXISTING LIGHT FROM BULKHEAD/ PIPE AND BRING ABOVE THE WATER LINE.
- 2: CUT POWER CABLE AS CLOSE TO BACK OF EXISTING LIGHT AS POSSIBLE.

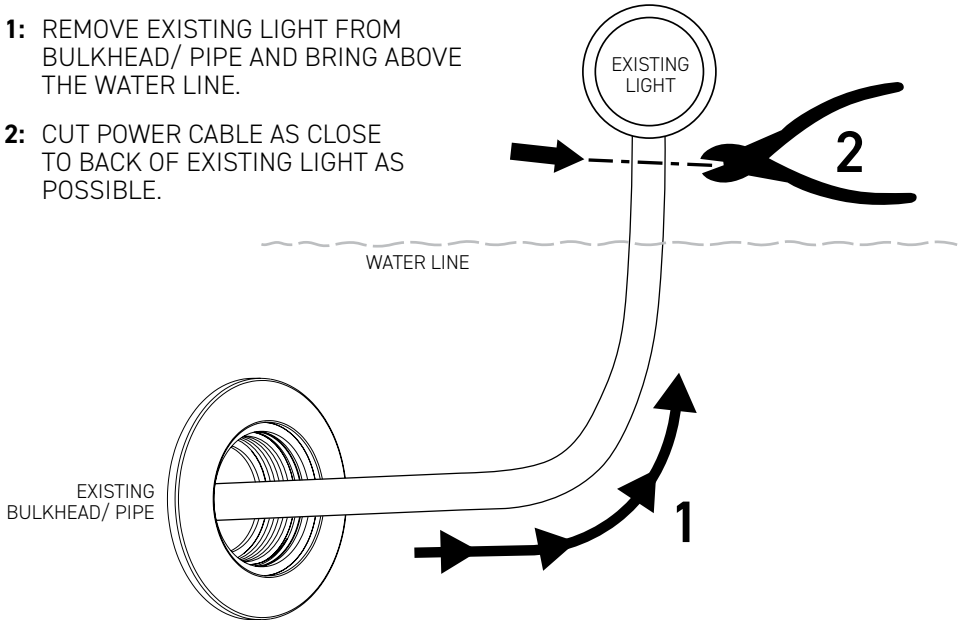

IMPORTANT NOTE



ALL CABLE & PLUG CONNECTIONS ARE TO BE DONE AT SURFACE LEVEL, AND OUT OF WATER.

IF EXISTING CABLE IS NOT LONG ENOUGH TO BRING ABOVE WATER LINE, THE CABLE WILL NEED TO BE DRAWN THROUGH CONDUIT/PIPE. ENSURE APPROPRIATE MEASURES ARE TAKEN TO PULL BACK CABLE FOR RE-CONNECTION.

FOR COLDER CLIMATES, IT IS RECOMMENDED TO LOWER THE WATER LEVEL TO BELOW THE EXISTING LIGHT TO AVOID TRAPPING WATER IN THE PIPE DURING INSTALLATION.

2: CONNECTION TO CABLE

2.1 CABLE PREPARATION

STRIP THE END OF THE EXISTING POWER CABLE TO SPECIFIED LENGTH.

NOTE



IF CABLE LENGTH ALLOWS, CUT CABLE BACK UNTIL FRESH COPPER APPEARS.

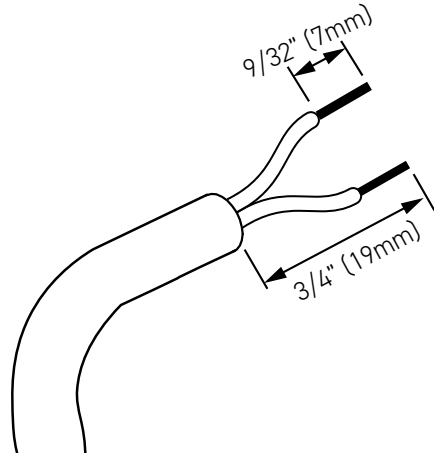

ALL CABLE & PLUG CONNECTIONS ARE TO BE DONE AT SURFACE LEVEL, AND OUT OF WATER.

2.2 DISASSEMBLE CABLE JOINER

1: ON THE SUPPLIED CABLE ASSEMBLY, STARTING FROM THE OPEN END, LOOSEN THE FIRST PART OF THE CABLE JOINER BY TWISTING THE INDICATED NUT ANTI-CLOCKWISE A FEW TIMES UNTIL IT IS FREE SPINNING.

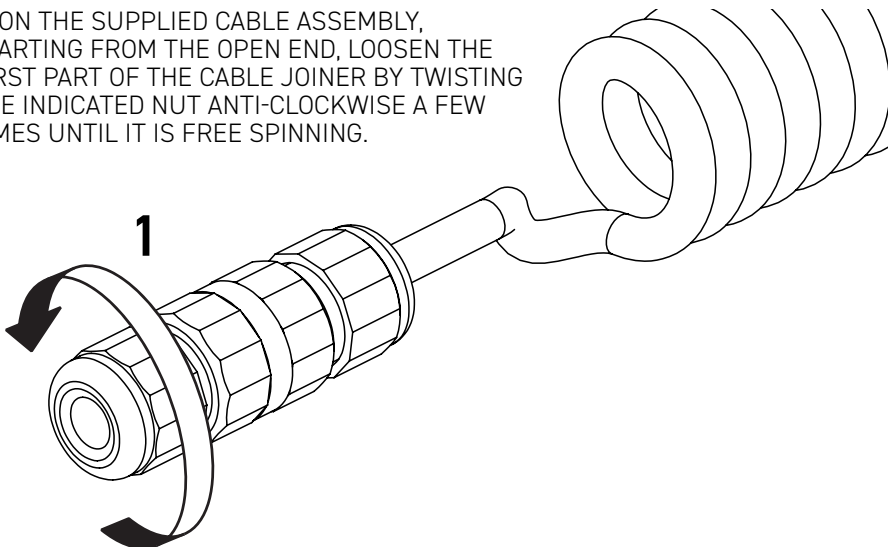

2.3

DISASSEMBLE CABLE JOINER ...CONTINUED

2: PULL OFF THE NUT AS INDICATED.

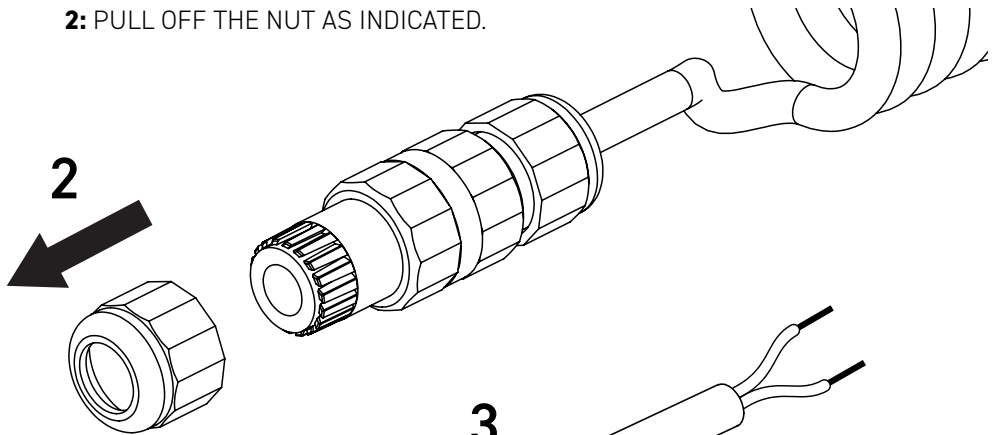

3

3: PLACE THE NUT OVER THE EXISTING CABLE.

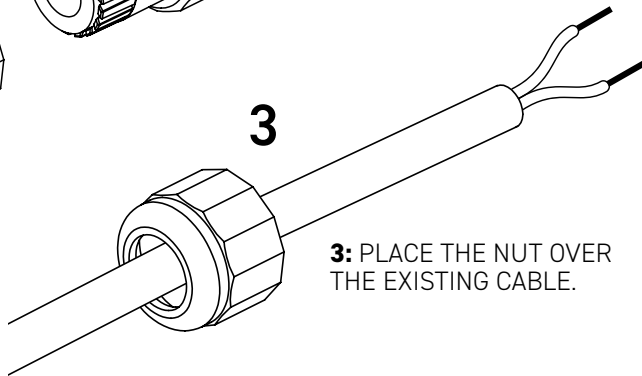

4: LOOSEN THE SECOND PART OF THE CABLE JOINER BY TWISTING THE INDICATED NUT ANTI-CLOCKWISE A FEW TIMES UNTIL IT IS FREE SPINNING.

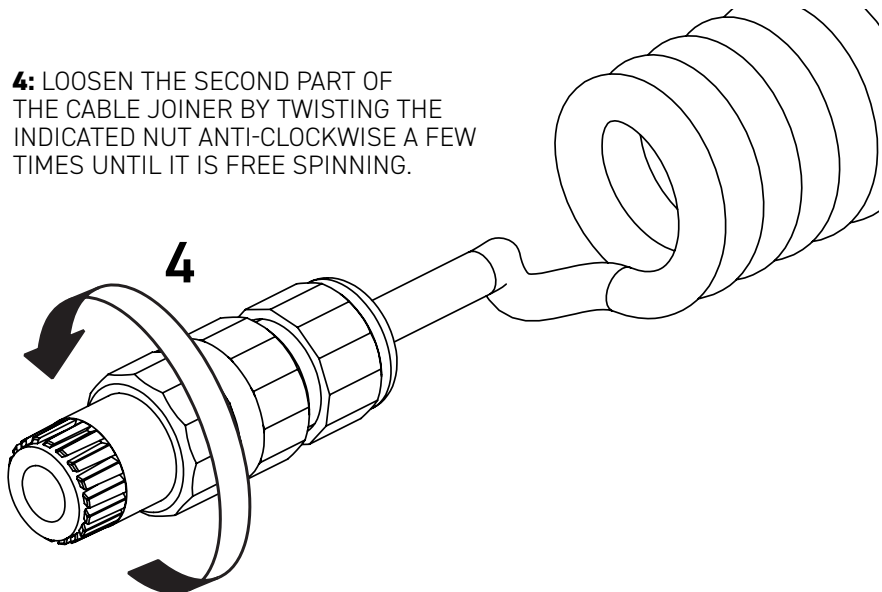

2.4 DISASSEMBLE CABLE JOINER ...CONTINUED

5: PULL OFF THE NUT WITH GROMMET INSIDE AS INDICATED.

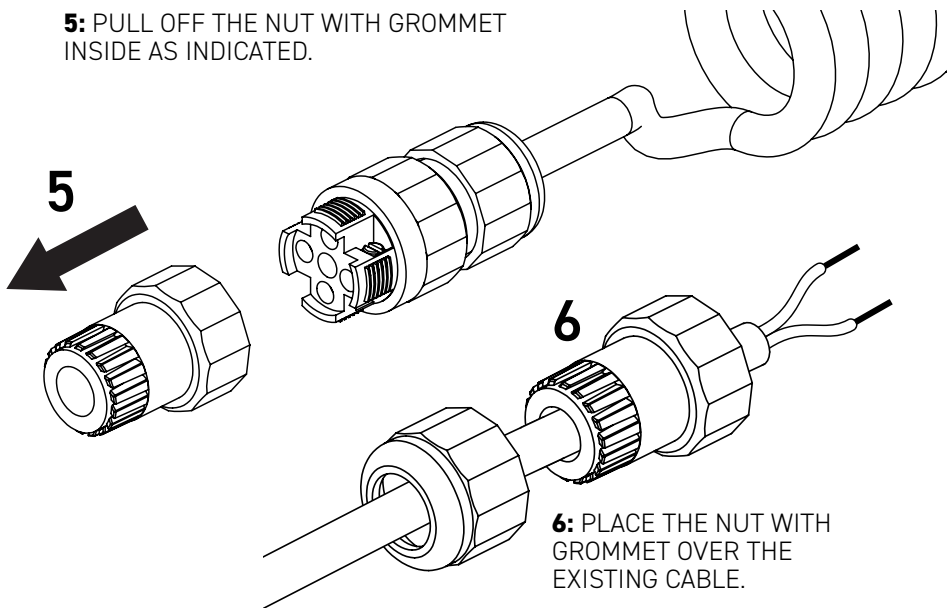

6: PLACE THE NUT WITH GROMMET OVER THE EXISTING CABLE.

2.5 ATTACH EXISTING CABLE TO JOINER

- 1:** USE A FLAT BLADE SCREWDRIVER TO LOOSEN THE FASTENERS ON EITHER SIDE OF THE CABLE JOINER.
- 2:** FEED THE TWO STRIPPED ENDS OF THE EXISTING CABLE INTO THE METAL TERMINALS IN THE CABLE JOINER.
- 3:** USE A FLAT BLADE SCREWDRIVER TO RE-TIGHTEN THE FASTENERS ON EITHER SIDE OF THE CABLE JOINER.

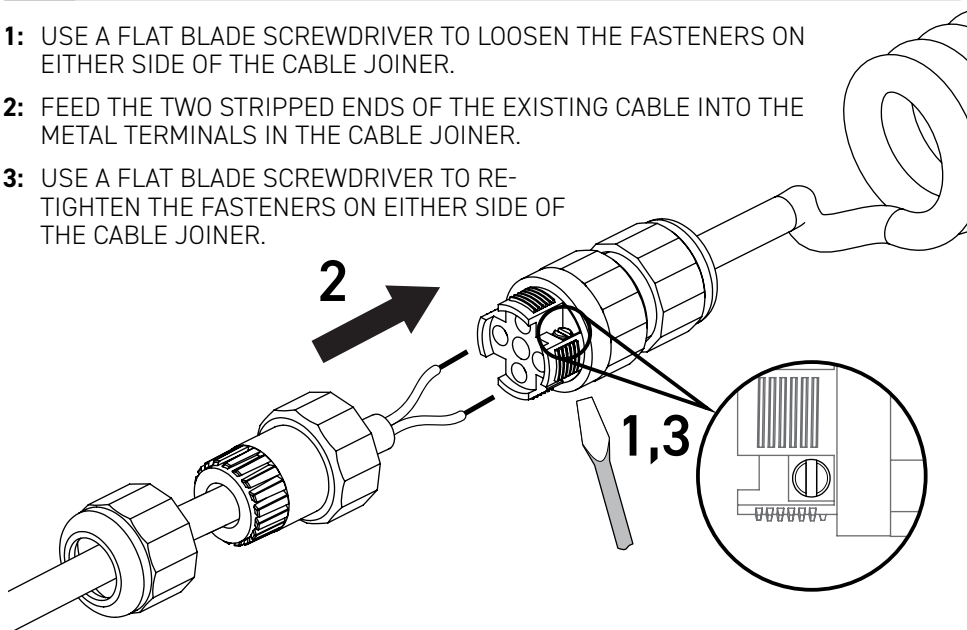

2.5

ATTACH EXISTING CABLE TO JOINER ...CONTINUED

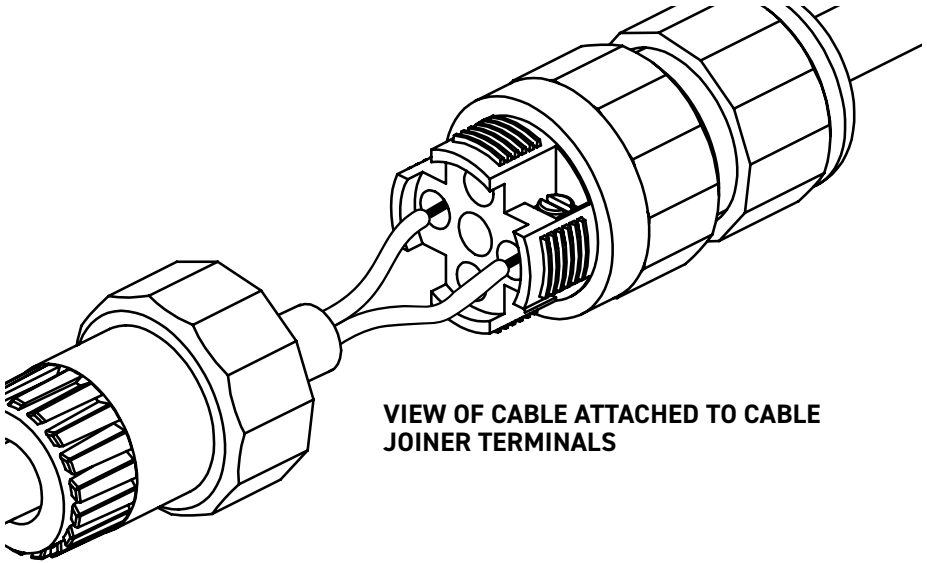

VIEW OF CABLE ATTACHED TO CABLE JOINER TERMINALS

2.6

REASSEMBLE CABLE JOINER

1: FEED THE NUT WITH GROMMET BACK ONTO THE CABLE JOINER.

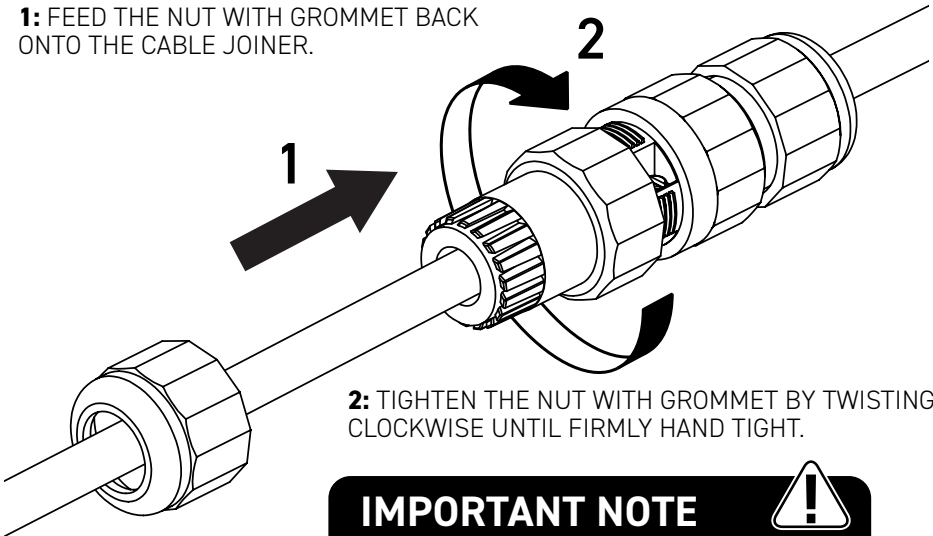

2: TIGHTEN THE NUT WITH GROMMET BY TWISTING CLOCKWISE UNTIL FIRMLY HAND TIGHT.

IMPORTANT NOTE



ENSURE NUT IS NOT CROSS-THREADED AND EVENLY SEATED ONCE RE-ATTACHED.

2.7

REASSEMBLE CABLE JOINER ...CONTINUED

1: FEED THE NUT BACK ONTO THE CABLE JOINER.

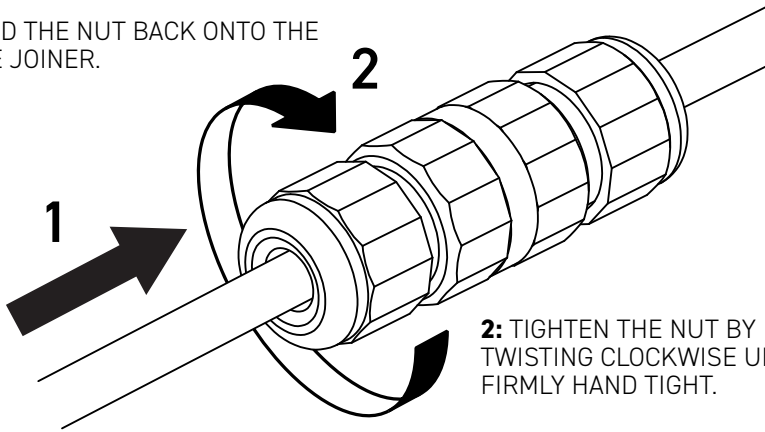

2.8

FEED CABLE ASSEMBLY INTO PIPE/BULKHEAD

FEED THE COMPLETED CABLE ASSEMBLY INTO PIPE/ BULKHEAD FITTING.

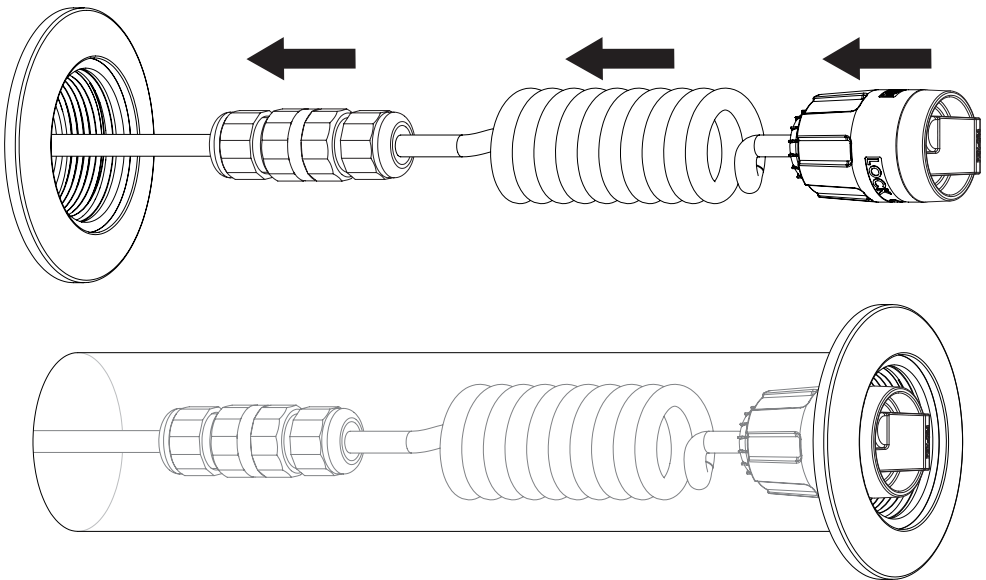

3: 1 1/2" THREADED ADAPTOR INSTALL

3.1 INSERT VINYL SPACER - VINYL BULKHEADS ONLY-

FOR VINYL BULKHEADS, INSERT THE VINYL SPACER INTO THE BACK OF THE HAYWARD 1 1/2" THREADLESS BULKHEAD.

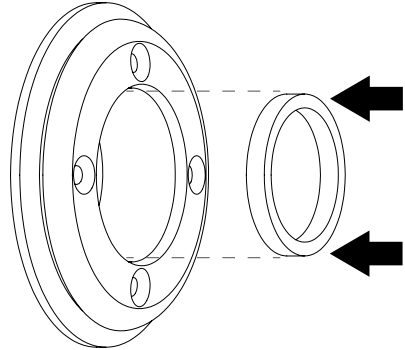

3.2 ATTACH CAP TO THREADED ADAPTER

HALF THREAD THE INCLUDED 1 1/2" THREADED CAP INTO THE THREADED ADAPTER. THIS WILL MAKE IT EASIER TO CORRECTLY INSERT THE THREADED ADAPTER IN THE NEXT STEP.

DO **NOT** THREAD THE CAP MORE THAN HALFWAY INTO THE ADAPTER.

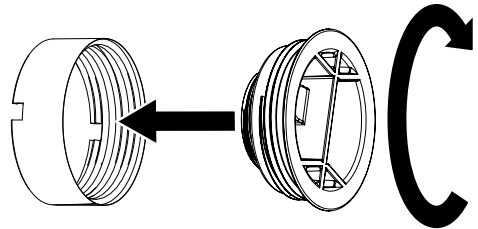

3.3 INSERT THREADED ADAPTER

INSERT THE THREADED ADAPTER INTO THE BULKHEAD.

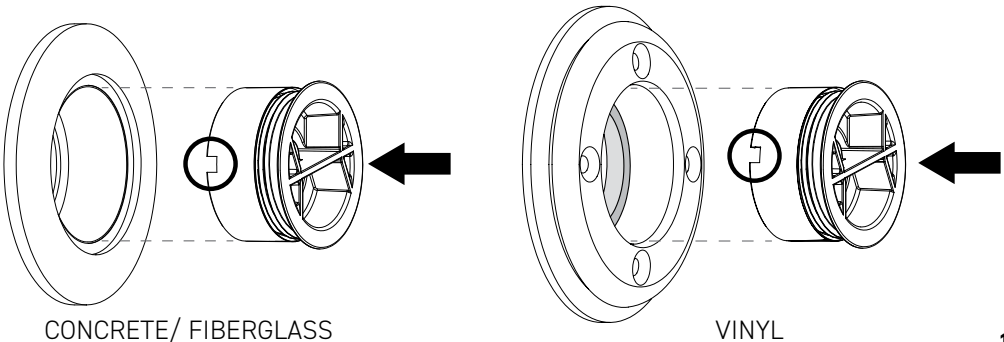

3.4 INSERT THREADED ADAPTER ...CONTINUED - CONCRETE & FIBERGLASS ONLY -

FOR CONCRETE AND FIBERGLASS BULKHEADS, YOU MAY NOTICE THE FITMENT INTO THE BULKHEAD IS LOOSE.

IF THE FITMENT IS LOOSE, TRY ONE OF THE FOLLOWING RECOMMENDED OPTIONS TO CREATE A MORE SECURE FITMENT:

OPTION A: USE **TEFLON TAPE** AROUND THE OUTSIDE OF THE THREADED ADAPTER. USE ANY NUMBERS OF LAYERS OF TEFLON TAPE THAT IS APPROPRIATE TO CREATE A TIGHTER FITMENT.

OPTION B: **LOWER THE WATER LEVEL** TO BELOW THE BULKHEAD, THEN USE A **NEUTRAL CURING SILICONE** TO SECURE THE THREADED ADAPTER IN PLACE. ENSURE THE SILICONE IS CURED BEFORE CONTINUING WITH THE REST OF THE INSTALLATION.

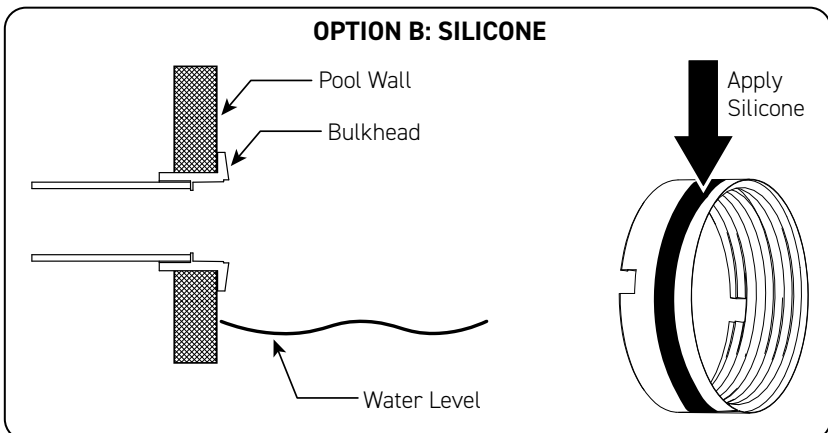
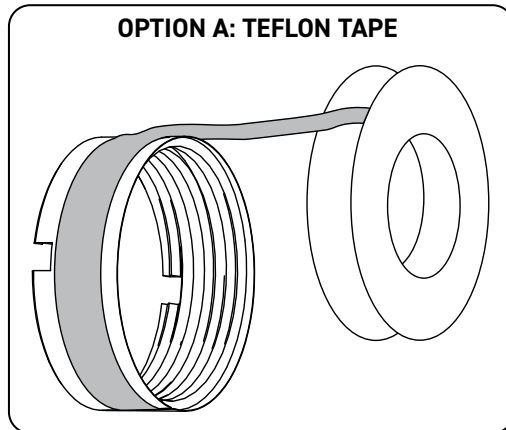

3.5

REMOVE THREADED CAP AND CONFIRM CORRECT FITMENT

REMOVE THE CAP FROM THE THREADED ADAPTER.

CONFIRM THE ADAPTER IS FULLY INSERTED INTO THE BULKHEAD.

USE THE FOLLOWING DIAGRAMS TO CHECK THE EXPECTED GAPS AS REFERENCE TO ENSURE CORRECT FITMENT.

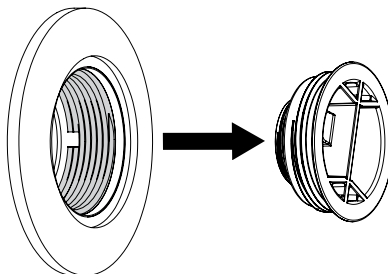

CONCRETE & FIBERGLASS

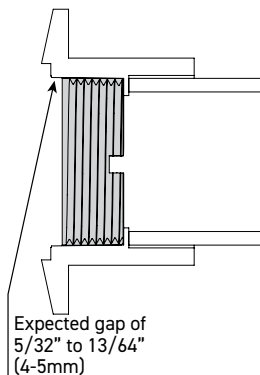
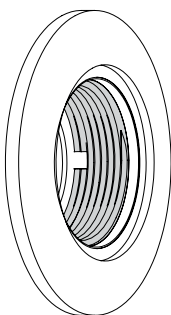

VINYL

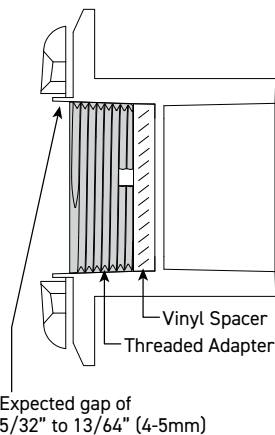
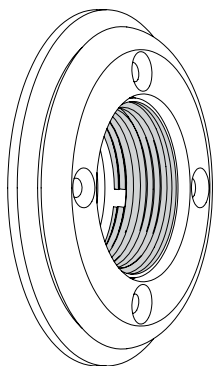

4: 1 1/2" PIPE FRICTION SLEEVE INSTALL

4.1 REMOVE THREADED SLEEVE

1. INSERT THE LIGHT INSTALLATION TOOL INTO THE FRONT OF THE LIGHT ASSEMBLY. ALIGNING THE TEETH ON THE TOOL WITH THE SLOTS ON THE RIM.
2. HOLD THE LOCKING TOOL SO THE LIGHT ASSEMBLY DOES NOT ROTATE WHEN REMOVING THE THREADED SLEEVE IN STEP 3 BELOW.

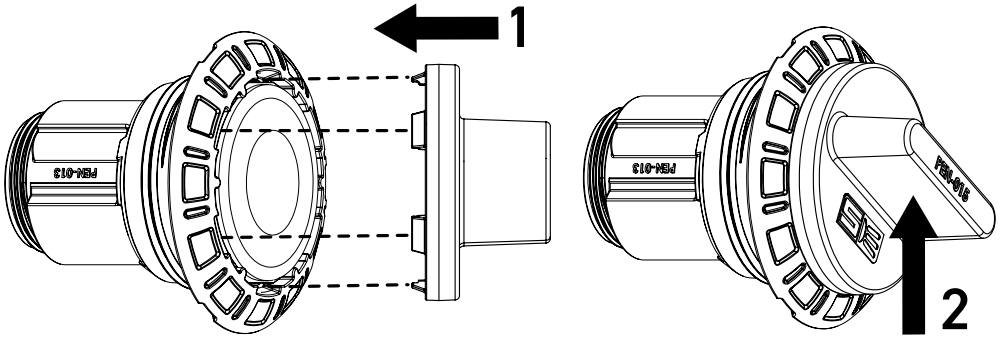

3. TWIST THE THREADED SLEEVE ANTI-CLOCKWISE TO UNLOCK IT.
4. THEN SLIDE THE SLEEVE OFF THE LIGHT ASSEMBLY.

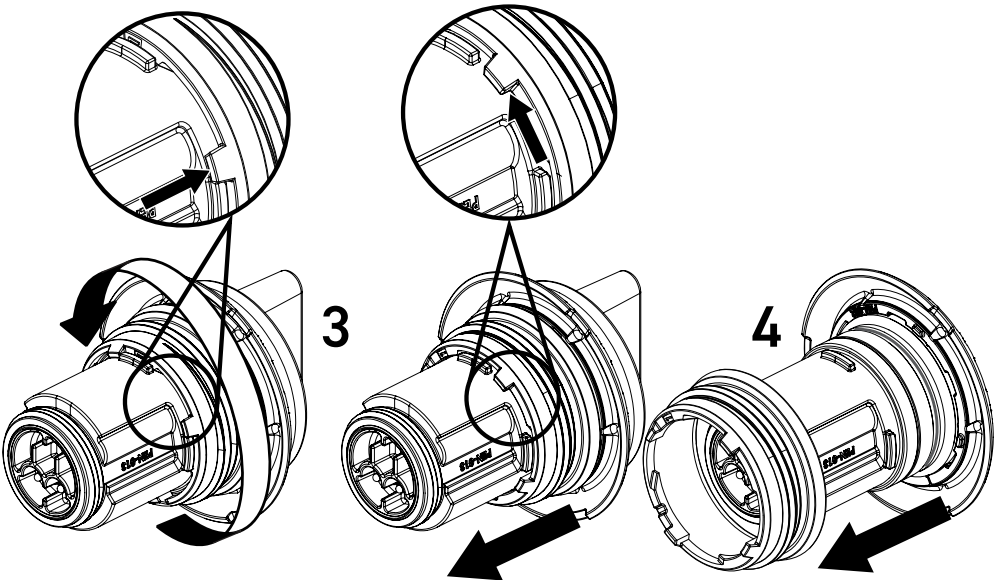

4.2

ATTACH 1 ½" PIPE FRICTION SLEEVE

1. CORRECTLY ALIGN THE 1 ½" FRICTION SLEEVE AND THE LIGHT ASSEMBLY. THE 1 ½" FRICTION SLEEVE ONLY ATTACHES CORRECTLY ONTO ONE SIDE OF THE LIGHT ASSEMBLY.

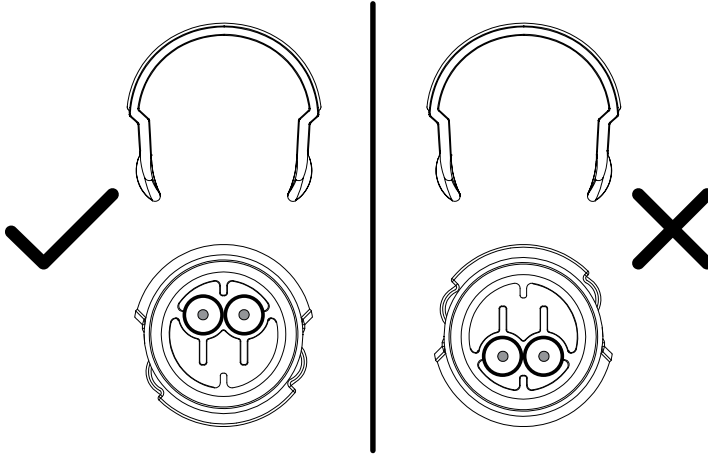

2. FIT THE 1 ½" FRICTION SLEEVE OVER THE LIGHT ASSEMBLY.

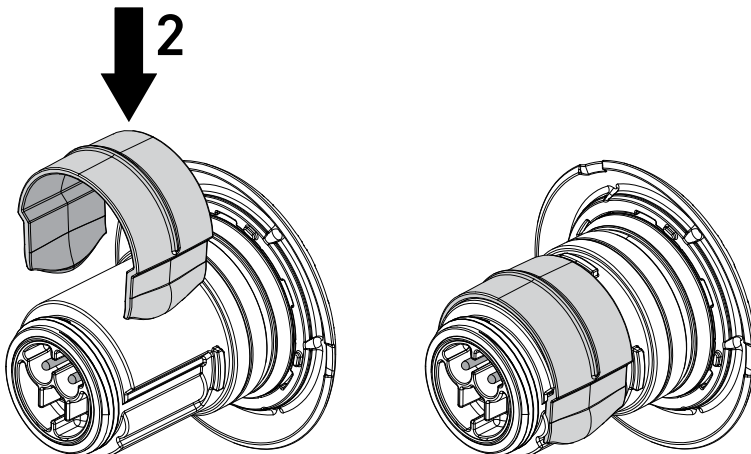

5: LIGHT ASSEMBLY

BEFORE ATTACHING THE LIGHT ASSEMBLY TO THE CABLE, CONSIDER WHICH OF THE TWO SIZES OF INCLUDED RIMS YOU WISH TO USE.

BOTH RIMS CAN BE USED FOR ANY INSTALLATION TYPE BUT, DEPENDING ON THE EXISTING BULKHEAD AND POOL WALL, YOU MAY WISH TO USE ONE OVER THE OTHER.

IF YOU WISH TO CHANGE RIMS, PLEASE FOLLOW SECTIONS **RIM & THREADED SLEEVE REMOVAL** AND **RIM & THREADED SLEEVE INSTALL** IN THIS INSTALLATION GUIDE.

THESE STEPS WILL GUIDE YOU THROUGH REMOVING THE PRE-ATTACHED RIM AND REPLACING IT WITH THE DESIRED RIM SIZE.

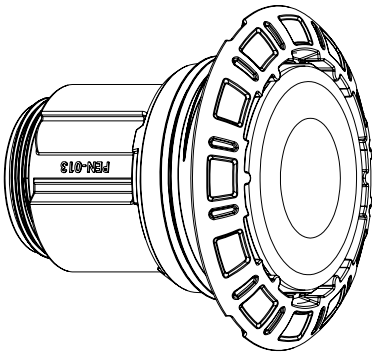

**VIEW OF LIGHT ASSEMBLY WITH
SMALL RIM ATTACHED.**

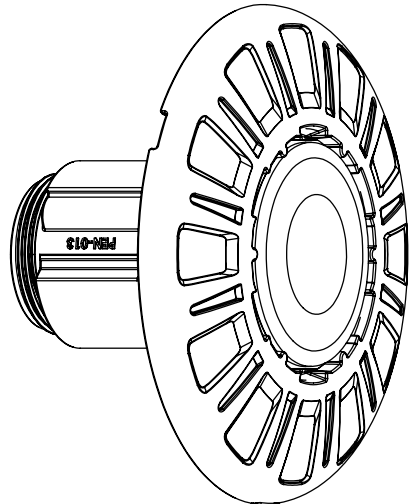

**VIEW OF LIGHT ASSEMBLY WITH
LARGE RIM ATTACHED.**

5.1

PULL PLUG ASSEMBLY OUT

PULL THE PLUG ASSEMBLY OUT OF THE PIPE/
BULKHEAD AND ABOVE THE WATER LINE.

THE COILED SECTION OF CABLE CAN EASILY BE UN-
COILED/ STRETCHED OUT, ALLOWING THE CABLE
JOINER TO STAY INSIDE THE PIPE.

**ALL CABLE & PLUG CONNECTIONS ARE TO BE DONE
AT SURFACE LEVEL, AND OUT OF WATER.**

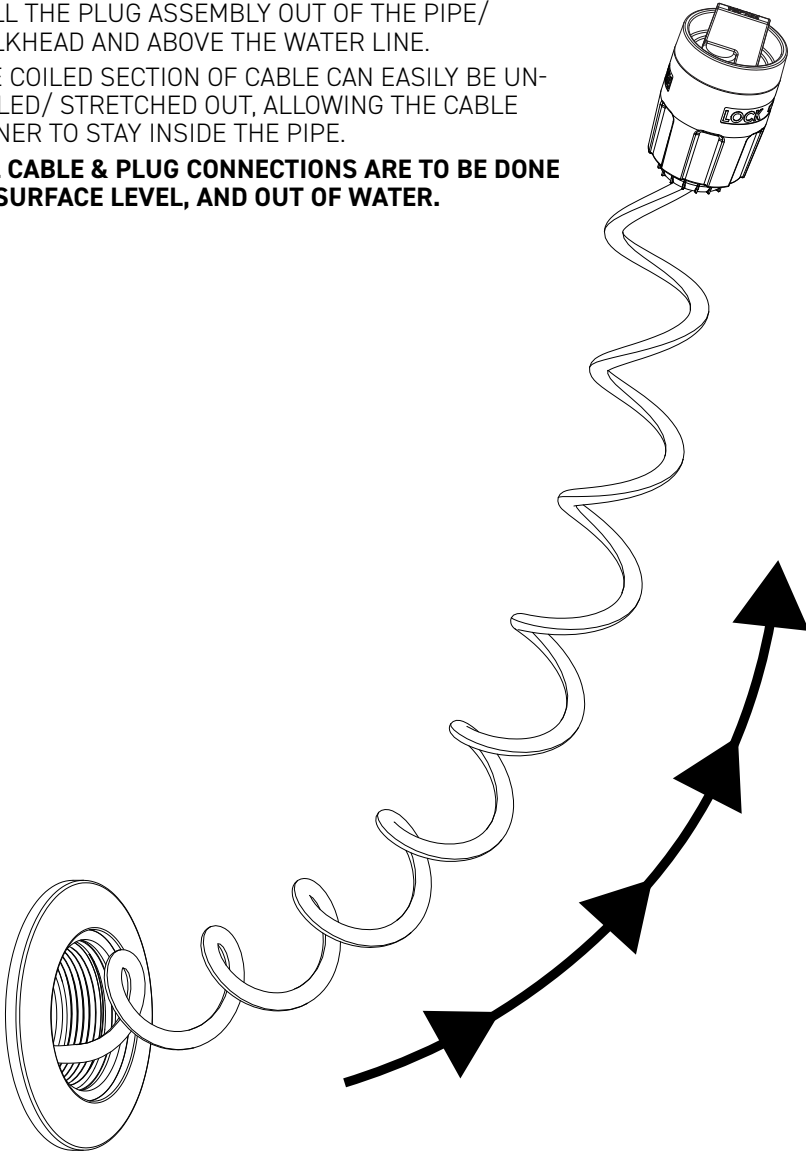

5.2 REMOVE PLUG COVER

WHEN READY TO ATTACH THE LIGHT ASSEMBLY, REMOVE THE PLUG **COVER** BY TWISTING THE **COLLAR** ANTI-CLOCKWISE A FEW TIMES UNTIL IT IS FREE SPINNING.

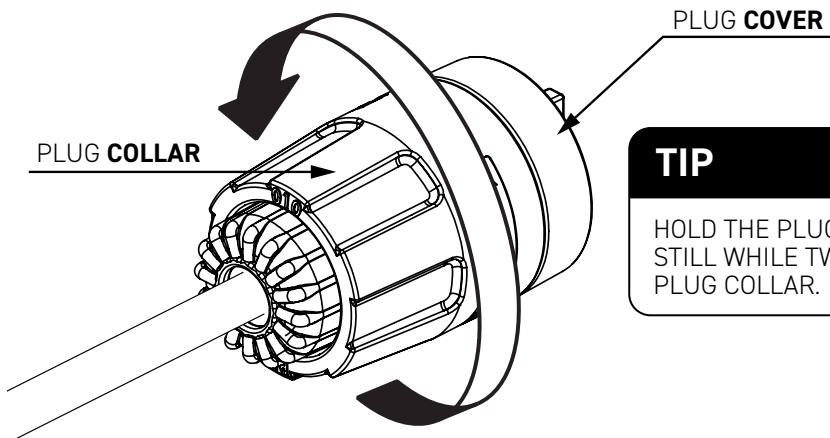

TIP



HOLD THE PLUG COVER STILL WHILE TWISTING THE PLUG COLLAR.

5.3 REMOVE PLUG COVER

DISCONNECT PLUG COVER FROM PLUG BY PULLING APART.

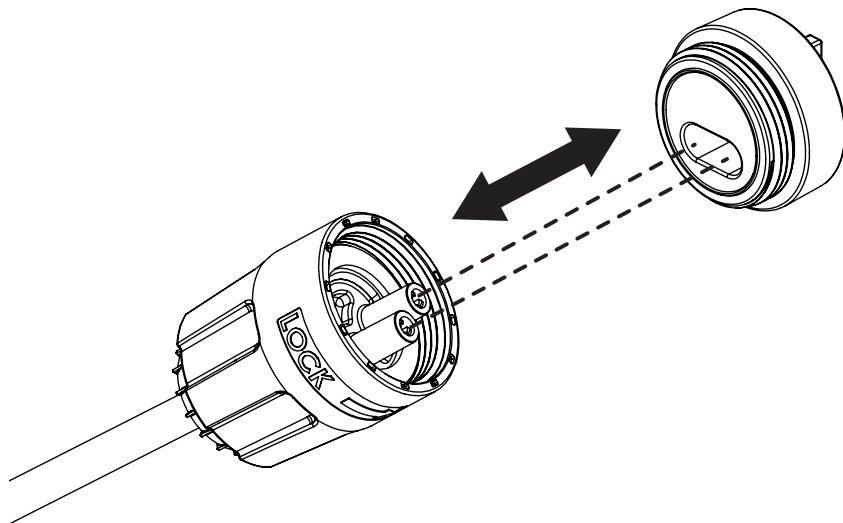

5.4 CONNECT THE TERMINALS

ALIGN THE TERMINAL PINS ON THE PLUG AND BACK OF THE LIGHT ASSEMBLY AND FIRMLY CONNECT TOGETHER.

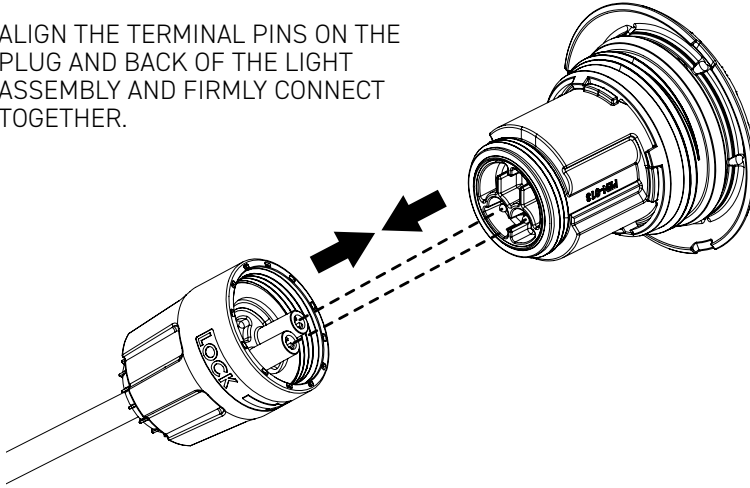

5.5 FASTEN PLUG TO LIGHT

TO LOCK INTO PLACE:
TWIST COLLAR CLOCKWISE A FEW
TIMES UNTIL IT'S HAND TIGHT.

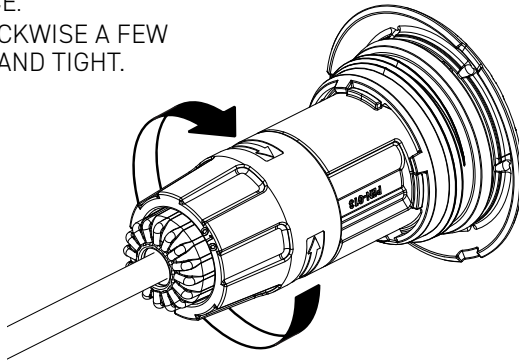

5.6 FEED IN CABLE & LIGHT ASSEMBLY

FEED THE COILED CABLE AND ATTACHED LIGHT ASSEMBLY INTO THE PIPE/ BULKHEAD.

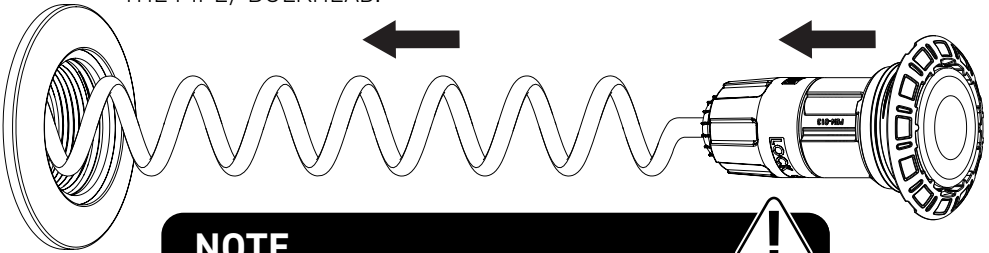

NOTE



IF FITMENT INTO THE PIPE IS TIGHT, ROTATING THE COILED CABLE SECTION CLOCKWISE WILL HELP PROVIDE CLEARANCE TO THE PIPE.

5.7 THREAD LIGHT INTO BULKHEAD FITTING

NOTE: THE FOLLOWING STEPS ARE NOT NECESSARY FOR INSTALLATION TYPE C: 1 1/2" SCH40 PIPE INSTALLATION.

1. JUST BEFORE FULLY INSERTING THE LIGHT INTO THE BULKHEAD, ROTATE THE LIGHT CLOCKWISE A COUPLE TURNS.
2. INSERT THE LIGHT INSTALLATION TOOL INTO THE FRONT OF THE LIGHT ASSEMBLY, ALIGNING THE TEETH ON THE TOOL WITH THE SLOTS ON THE RIM.
3. TWIST THE LIGHT ASSEMBLY WITH THE TOOL CLOCKWISE INTO THE BULKHEAD FITTING UNTIL FIRMLY HAND TIGHT.

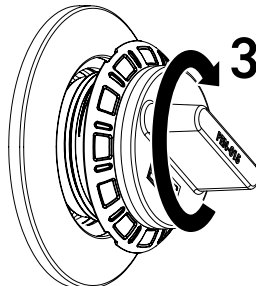
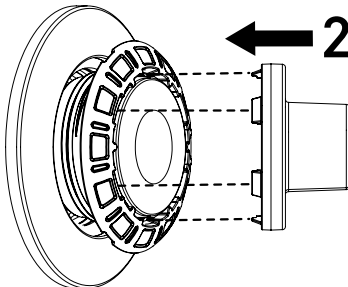
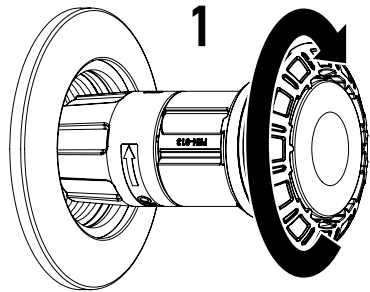

RIM & THREADED SLEEVE REMOVAL

1 REMOVE THREADED SLEEVE

1. INSERT THE LIGHT INSTALLATION TOOL INTO THE FRONT OF THE LIGHT ASSEMBLY. ALIGNING THE TEETH ON THE TOOL WITH THE SLOTS ON THE RIM.
2. HOLD THE LOCKING TOOL SO THE LIGHT ASSEMBLY DOES NOT ROTATE WHEN REMOVING THE THREADED SLEEVE IN STEP 3 BELOW.

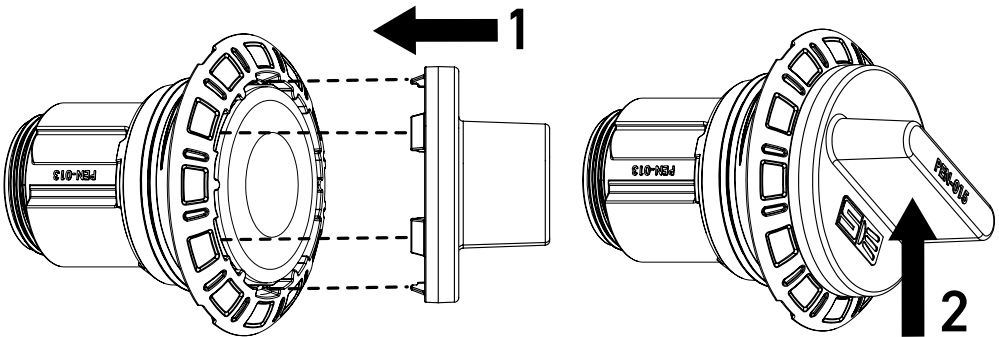

3. TWIST THE THREADED SLEEVE ANTI-CLOCKWISE TO UNLOCK IT.
4. THEN SLIDE THE SLEEVE OFF THE LIGHT ASSEMBLY.

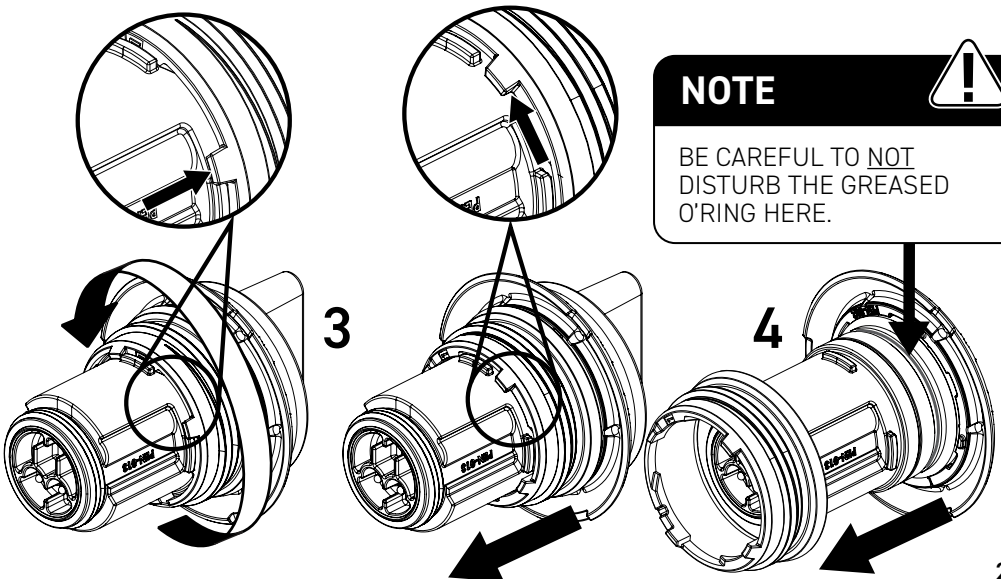

2

REMOVE RIM

WITH THE SLEEVE REMOVED, THE RIM CAN BE CLIPPED OFF THE LIGHT ASSEMBLY. REMOVE THE RIM BY HAND ONLY.

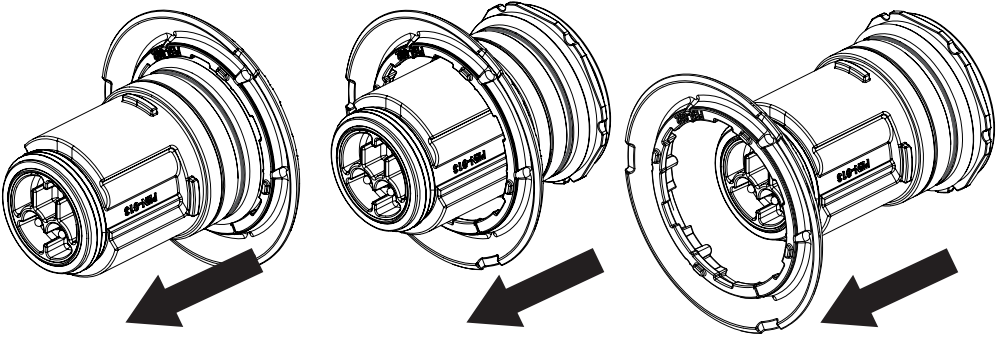

RIM & THREADED SLEEVE INSTALL

1

ATTACH RIM

ALIGN THE RIM AND SLIDE IT OVER THE LIGHT ASSEMBLY UNTIL IT SNAPS INTO PLACE AND IS FULLY SEATED AS INDICATED. DO THIS BY HAND ONLY.

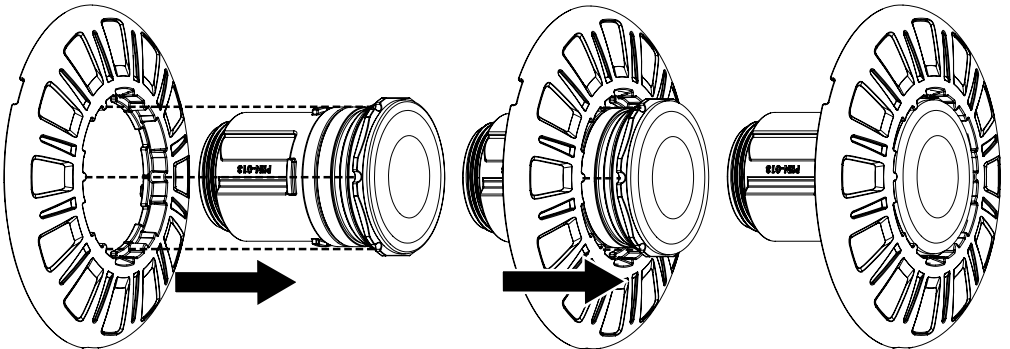

NOTE THE INDICATED ALIGNMENT POINTS ON THE RIM AND LIGHT ASSEMBLY.

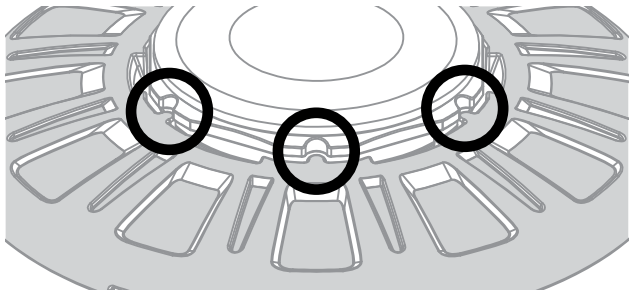

2

ATTACH THREADED SLEEVE

1. INSERT THE LIGHT INSTALLATION TOOL INTO THE FRONT OF THE LIGHT ASSEMBLY. ALIGNING THE TEETH ON THE TOOL WITH THE SLOTS ON THE RIM.
2. HOLD THE LOCKING TOOL SO THE LIGHT ASSEMBLY DOES NOT ROTATE WHEN ATTACHING THE THREADED SLEEVE IN STEP 4 BELOW.

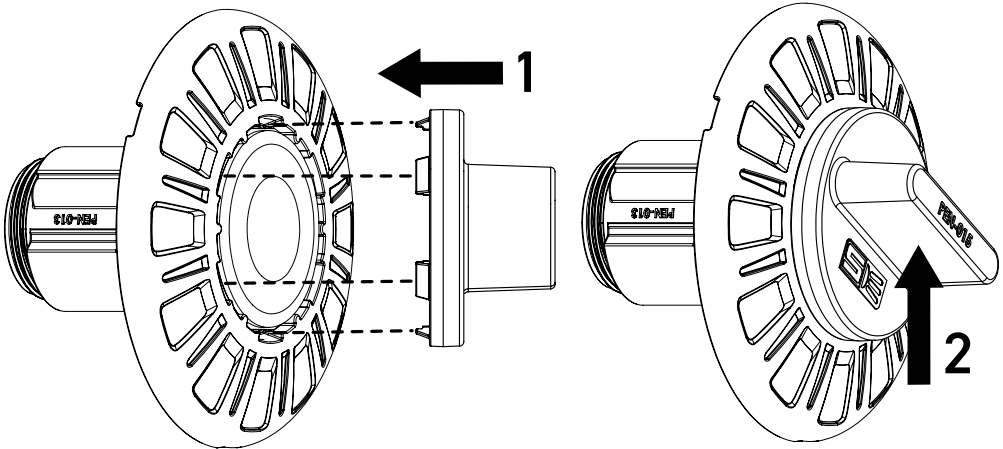

3. TWIST THE THREADED SLEEVE CLOCKWISE TO LOCK IT. NOTE THE POSITION OF THE INDICATED TAB.
4. SLIDE THE THREADED SLEEVE ONTO THE LIGHT ASSEMBLY.

NOTE



BE CAREFUL TO NOT DISTURB THE GREASED O'RING HERE.

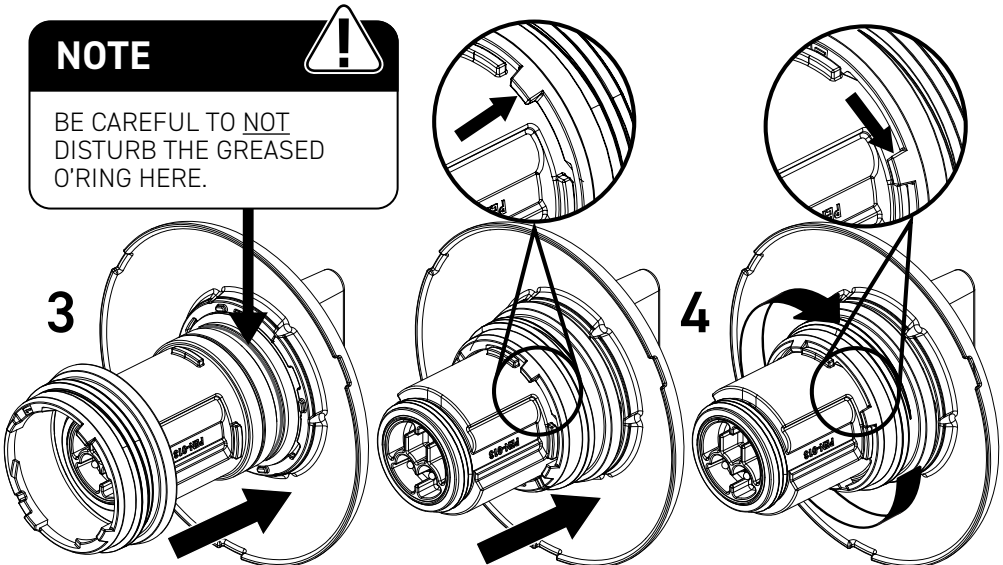

WINTERIZATION

THE FOLLOWING WINTERIZATION PROCESS IS HIGHLY RECOMMENDED TO AVOID DAMAGE TO THE LIGHT ASSEMBLY AND THE SUPPORTING FIXTURES.

SELECT FROM COMMONLY AVAILABLE WINTERIZATION FITTINGS TO SEAL THE NICHELESS FITTING/ BULKHEAD. IT IS IMPORTANT TO ENSURE THEY ARE APPROPRIATELY SELECTED AND FITTED TO ENSURE A WATER TIGHT SEAL IS ACHIEVED. ANY WATER IN THE PIPE MUST BE BLOWN OUT BEFORE SEALING OFF.

THIS PROCESS IS RECOMMENDED. ANY DAMAGE TO THE TERMINAL PLUG OR PIPE FITTING DUE TO INADEQUATE SEALING OF THE 1 ½" FITTING WILL NOT BE WARRANTED BY SPA ELECTRICS.

1 LOWER WATER LEVEL

LOWER WATER LEVEL TO BELOW THE LIGHT.

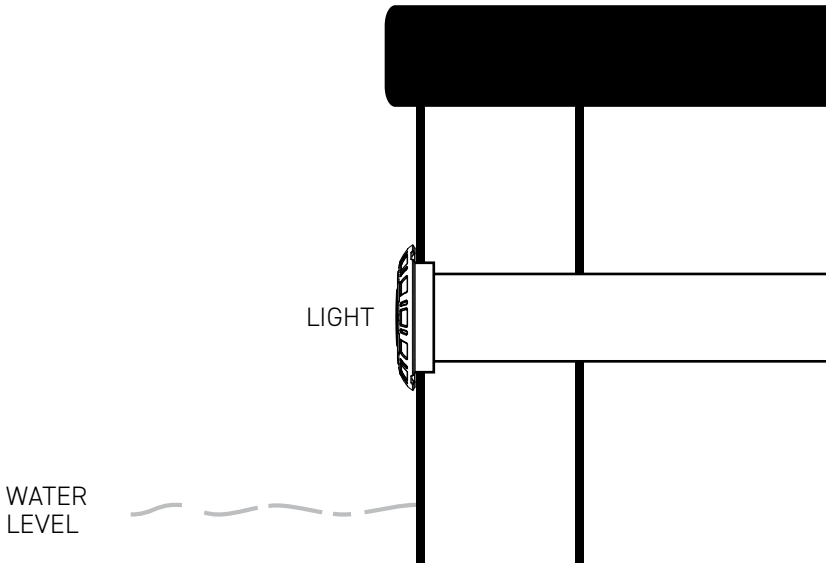

2

UN-THREAD LIGHT FROM BULKHEAD

*NOTE: THE FOLLOWING STEP IS NOT NECESSARY FOR A **INSTALLATION TYPE C: 1 1/2" SCH40 PIPE INSTALLATION**. SKIP TO STEP 2: PULL LIGHT OUT OF PIPE/BULKHEAD.*

1. INSERT THE LIGHT INSTALLATION TOOL INTO THE FRONT OF THE LIGHT ASSEMBLY, ALIGNING THE TEETH ON THE TOOL WITH THE SLOTS ON THE RIM.
2. TWIST THE LIGHT ASSEMBLY WITH THE TOOL ANTI-CLOCKWISE TO UN-THREAD FROM THE BULKHEAD FITTING.

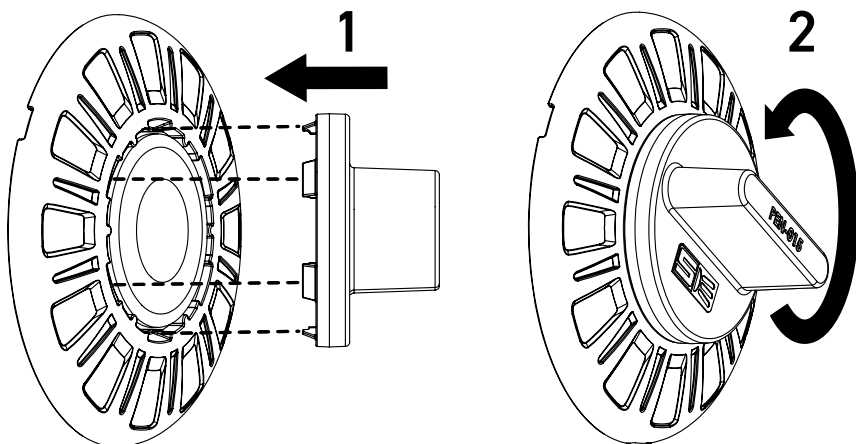

3

PULL LIGHT OUT OF PIPE/ BULKHEAD

PULL LIGHT ASSEMBLY WITH PLUG ATTACHED OUT OF THE BULKHEAD FITTING.

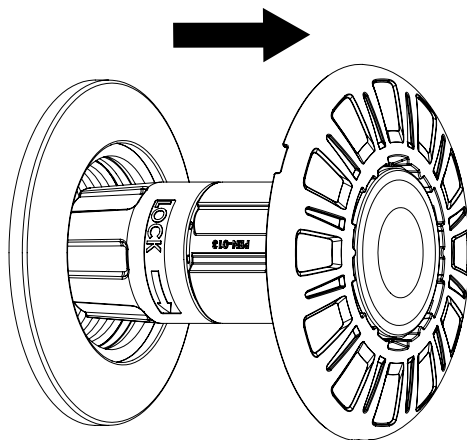

4

REMOVE PLUG FROM LIGHT

UNSCREW PLUG COLLAR ANTI-CLOCKWISE UNTIL IT IS FREE SPINNING.

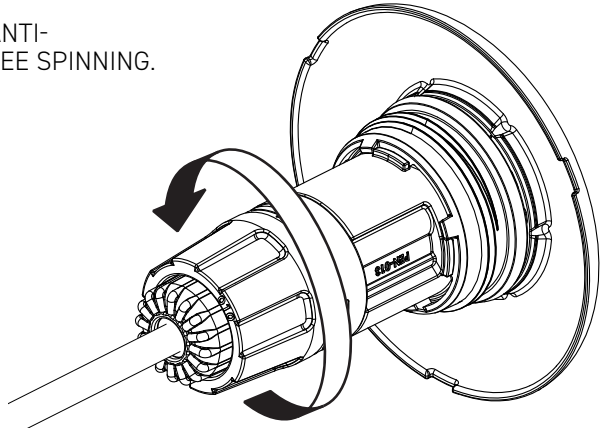

IMPORTANT NOTES



CABLE SHOULD BE SECURED ABOVE WATER AND WEATHER PROTECTED WHILE LIGHT IS DETACHED.

5

REMOVE PLUG FROM LIGHT

DISCONNECT LIGHT ASSEMBLY FROM PLUG BY PULLING APART.

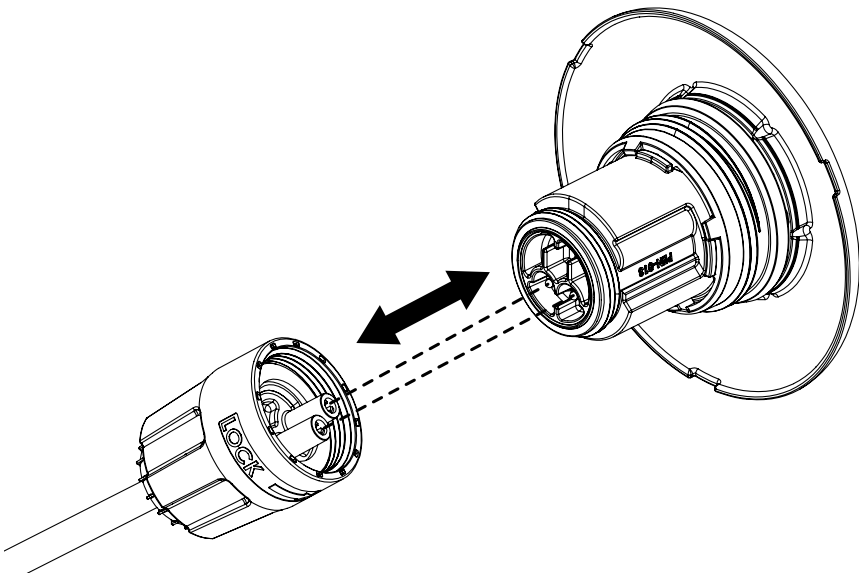

6

ATTACH PLUG COVER TO PLUG

ALIGN THE TERMINAL PINS ON THE PLUG WITH THE SLOT ON THE PLUG COVER AND CONNECT TOGETHER.

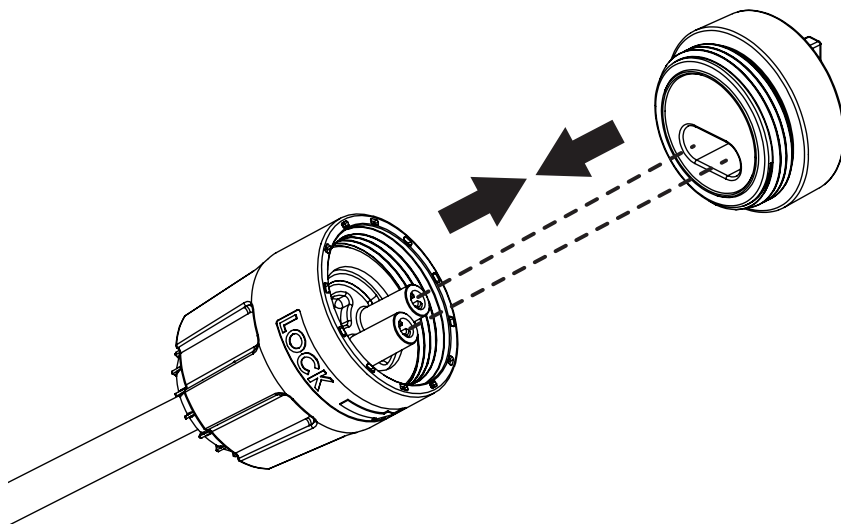

7

FASTEN PLUG COVER

TO LOCK INTO PLACE:

TWIST THE PLUG **COLLAR** CLOCKWISE A FEW TIMES UNTIL IT'S HAND TIGHT.

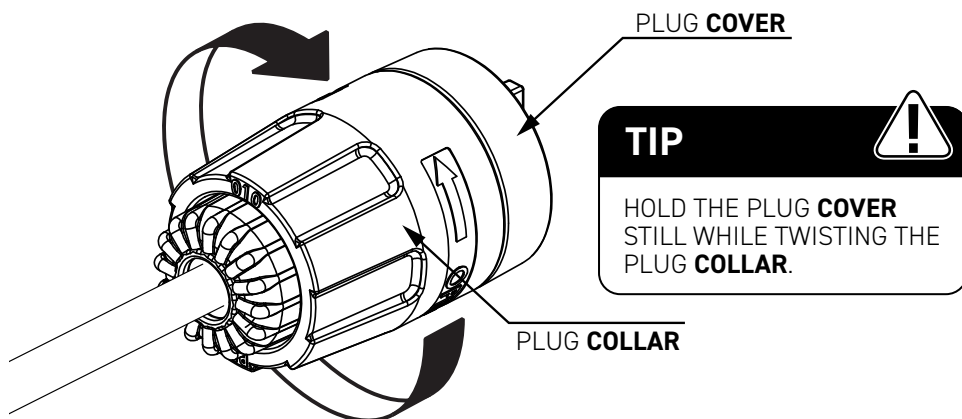

8

REMOVE WATER FROM PIPE

REMOVE THE REMAINING WATER FROM THE PIPING, THIS MAY INVOLVE BLOWING OUT WITH COMPRESSED AIR.

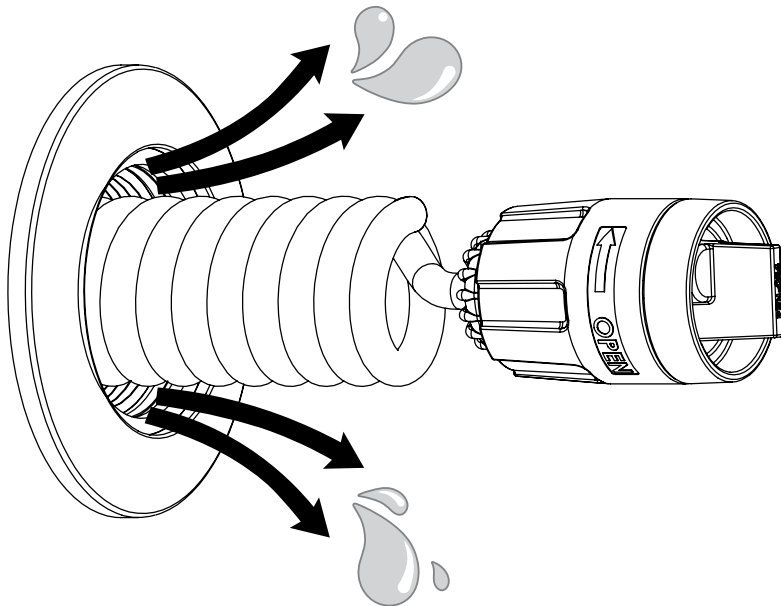

9

STORE CABLE

STORE CABLE BACK INTO THE PIPING.

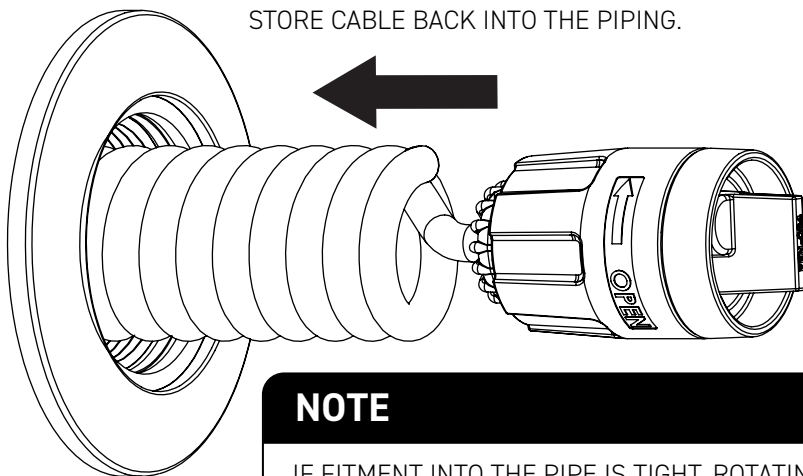

NOTE



IF FITMENT INTO THE PIPE IS TIGHT, ROTATING THE COILED CABLE SECTION CLOCKWISE WILL HELP PROVIDE CLEARANCE TO THE PIPE.

10

SEAL PIPE OPENING

SELECT FROM COMMONLY AVAILABLE WINTERIZATION FITTINGS TO SEAL OFF THE BULKHEAD FITTING, IT IS IMPORTANT TO ENSURE THEY ARE APPROPRIATELY SELECTED AND INSTALLED TO ACHIEVE A WATER TIGHT SEAL.

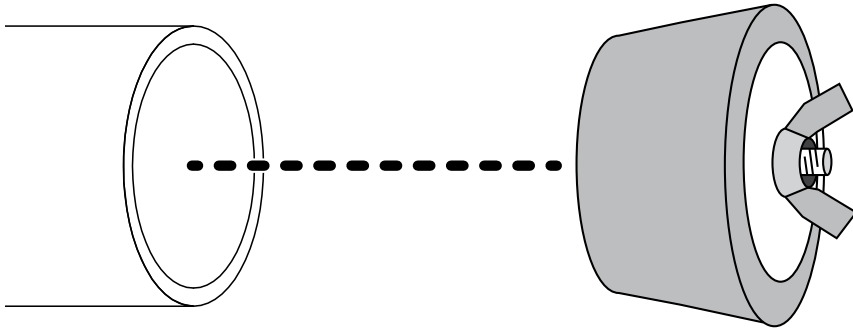
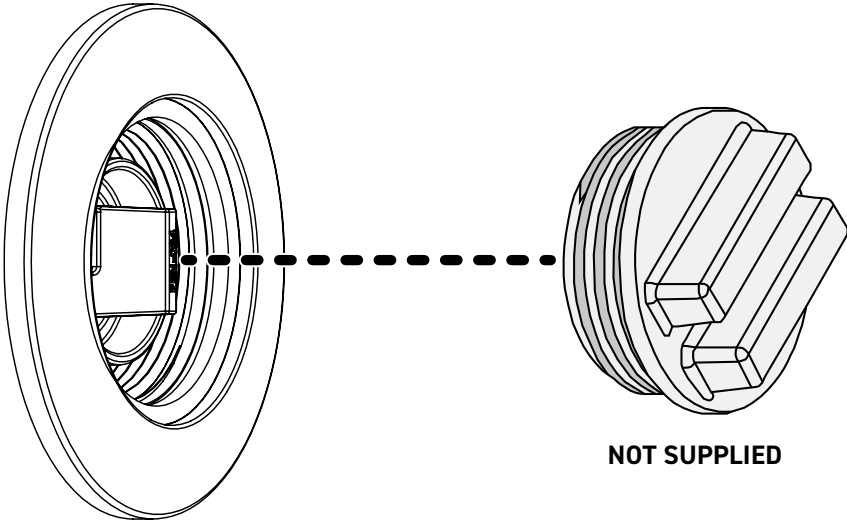

IMPORTANT NOTE

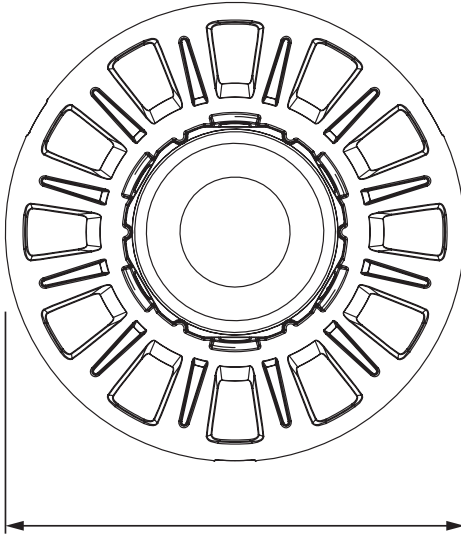

IMAGE OF SEALED FITTINGS SHOWN FOR REFERENCE ONLY. ENSURE THE CORRECT TYPE IS SELECTED TO SEAL OFF PIPE/ BULKHEAD.

KEY DIMENSIONS

A

LARGE RIM (FIBERGLASS/ VINYL)



3.8" (96mm)



0.48" (12.3mm)

B

SMALL RIM (CONCRETE)

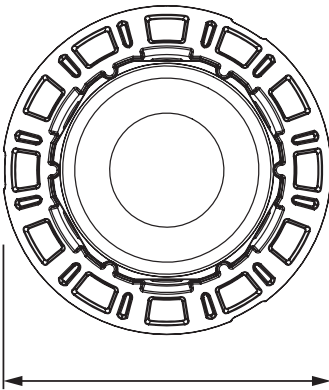

2.6" (66mm)



0.34" (8.5mm)

TROUBLESHOOTING

ISSUE	REASON	ACTION
Light returns to WHITE color during manual color change	Light synchronization process has been triggered	Refer to MULTI PLUS Installation & User Guide
Light flashes 2 times (RED)	Light over heating.	Check light is fully submerged. Check vents are not obstructed
Light not operating (1)	Faulty connection to transformer	Ensure low voltage cable is correctly connected to transformer terminals
Light not operating (2)	Main power not connected	Check transformer is connected to Main power (hardwired or plugged into a certified outlet) and the breaker is switched on
Light not operating (3)	Damaged cable	Disconnect plug top and test voltage under load using multi-meter (ie. 20w 12v)
Light not operating (4)	Transformer not working	Check fuses & test transformer using multimeter under load (ie.15W 12V)
Light colors not synchronized	Incorrect operating mode selected.	Refer to MULTI PLUS setup procedure

If these issues cannot be resolved with the above recommended actions, please contact your local Spa Electrics reseller or Spa Electrics directly.

www.spaelectrics.com

ELECTRICAL GROUNDING

Underwriters Laboratories (UL) Statement

Per the NEC, NFPA 70, Article 680.23 (B)(5), states that bonding shall not be required for luminaires that are listed for the application and have no non-current carrying metal parts. In addition, per Article 680.26 (B)(4), exception states that Listed low-voltage lighting systems with non-metallic forming shells shall not require bonding.

Therefore, luminaires with polymeric/non-current carrying metal parts are not required to be grounded / bonded.

Manufacturers Statement

Spa Electrics **Retro T1** luminaires with their plastic housing designs do not require grounding / bonding.

Spa Electrics **Retro T1** lights have also been determined to comply with the applicable requirements for wet-niche, LED type Swimming Pool and Spa Luminaires.

FCC COMPLIANCE STATEMENT

This device complies with part 15 of the FCC rules. Operation is subject to the following two (2) conditions:

1. This device may not cause harmful interference, and
2. This device must accept any interference received, including interference that may cause undesired operation.

Note: This equipment has been tested and found to comply with the limits for a Class B digital device, pursuant to part 15 of the FCC Rules. These limits are designed to provide reasonable protection against harmful interference in a residential installation. This equipment generates, uses and can radiate radio frequency energy and, if not installed and used in accordance with the instructions, may cause harmful interference to radio communications. However, there is no guarantee that interference will not occur in a particular installation. If this equipment does cause harmful interference to radio or television reception, which can be determined by turning the equipment off and on, the user is encouraged to try to correct the interference by one or more of the following measures:

- **Reorient or relocate the receiving antenna.**
- **Increase the separation between the equipment and receiver.**
- **Connect the equipment into an outlet on a circuit different to that to which the receiver is connected.**
- **Consult the dealer or an experienced radio / TV technician for help.**

Do not make any changes or modifications to the equipment unless otherwise specified in the manual.

PAGE INTENTIONALLY LEFT BLANK



IMPORTANT NOTE

PLEASE STORE THIS MANUAL IN A SAFE PLACE
FOR FUTURE REFERENCE



 **Spa Electrics[®]**

The underwater lighting specialists

spaelectrics.com

©COPYRIGHT 2026 SPA ELECTRICS INC.
ALL RIGHTS RESERVED

US 2026 02 09